

www.encon-india.com
www.tensileindia.com

ENCON[®]

ENCON[®] started in 1992, has come a long way from doing domes, skylights, atriums etc. in fiberglass & polycarbonate to tensile membrane structures . We are quick to adapt global influences & translate the same into our products & projects.

We have a policy of continuously improving our quality management systems.

We are pioneers in tensile covering in North India.

We have the best and most experienced manpower in this industry in North India.

Around 20 years back we had done a Open Air Theatre around 22000 sq ft the biggest at that time in North India.

In 2016 we have completed one of the biggest coverings in North India around 2,00,000 sq ft Atrium for Omaxe Connaught Place Mall, Greater Noida.

We are working with some of the best names in the construction industry like DLF,UNITECH,DIAL,OMAXE,MAHAGUN,EMAAR MGF,VATIKA,SUPERTECH,BESTECH,ASHIANA, ANSALS,ASCOT to name a few

We are working with some of the best architects like Hafeez Contractor, Sikka Associates, Spazio, Design Plus to name a few.

ENCON is the source for quality products. Our designs are the industry standard for innovative engineering.

We have in house M.S. & Aluminium fabrication .

We also have in house spray painting facility for M.S. framework.

We also have state of the art fabric welding facility.

We have a comprehensive range of imported tensile and other outdoor membranes in stock.

We have on our panel qualified structural designers who have experience in various International projects and work on some of the best softwares in this industry.

We have two production units

*Pace City II ,Gurgaon

*Chopanki, Bhiwadi

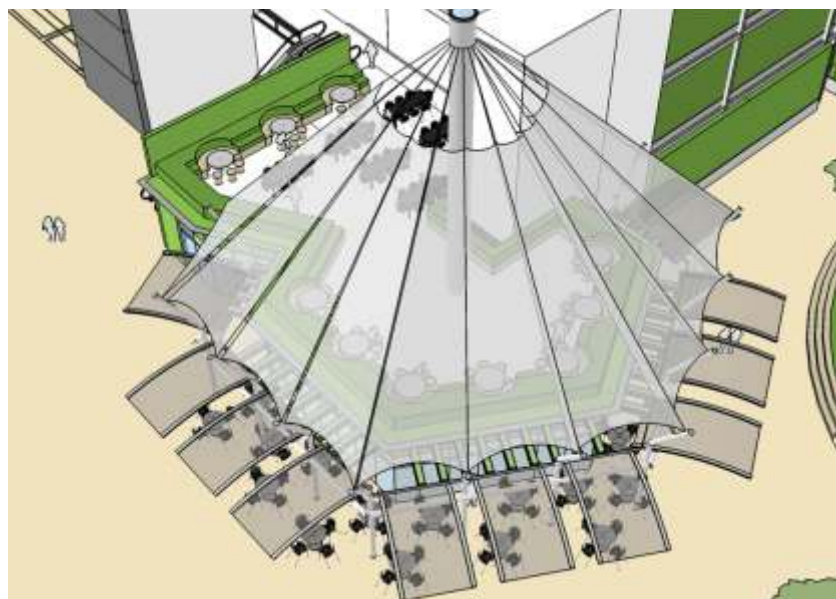

For us at ENCON, means of achieving growth are just as important as growth. We strive towards client, employee & supplier satisfaction in our business dealings.

TENSILE STRUCTURE, LIGHT WEIGHT STRUCTURE, MEMBRANE COVERING	4
<ul style="list-style-type: none"> Atrium Car Park/ Bus shelter Walk way covering Multipurpose covering Entrance Canopy Textile facade Sports covering 	
LANDSCAPE ELEMENTS	30
GAZEBO/ CABANA/ PERGOLA	37
KIOSK	76
RETRACTABLE/OPENABLE ROOF AND SUN CONTROL SYSTEMS(Motorized & Manual)	80
<ul style="list-style-type: none"> Retractable /openable roof systems Openable Skylight Skylight Shading, Fabric tension system 	
COTTAGE / PREFAB LIGHT WEIGHT ROOMS / Luxury Tent /INSULATED ROOM	89
<ul style="list-style-type: none"> COTTAGE House Extension Extra floor on terrace Site office Super Luxury tent Office Extension Luxury Tent Prefab home 	
AWNING & CANOPY	108
MESH SHADING APPLICATION	123
<ul style="list-style-type: none"> Skylight shading Play area shading Swimming pool shading Outdoor area shading 	
VERTICAL SCREEN / SEE THRU SCREEN	132
ROLLER BLIND	137
INTERIOR DESIGN ELEMENTS, WALL FEATURE, ART/CUSTOMIZED LIGHTS / INTERIOR AND STRETCH CEILING	138
<ul style="list-style-type: none"> Design elements Designer lights Screen Ceiling Wall Feature Ceiling & wall Paneling 	
CEILING& WALL PANELING	165
POLYCARBONATE COVERING / SKY LIGHT & ATRIUM	159
WROUGHT IRON/ CAST IRON/ FRP CANOPY	164
BANQUET	167
FRENCH VICTORIAN CONSERVATORY	170
LOUVER /PERGOLA / OFFICE BREAKOUT AREA	178
UMBRELLA, PARASOL & TENSILE UMBRELLA	182
<ul style="list-style-type: none"> Heavy duty customized umbrella and parasol Imported side pole umbrella Light duty umbrella for beach or branding Tensile umbrella Wooden umbrella 	
BALCONY EXTENSION / PRODUCTION FACILITY & MANPOWER	181
SHORT LIST OF OUR ESTEEMED CLIENTS	185

Atrium/Public places

Tensile membrane is the favoured covering material for atrium coverings in mall and commercial buildings. The membrane allows just the right amount of natural light and also eliminates the glare. It also helps in reducing the air conditioning cost, being flexible, design options are many.



Tensile membrane structures are quite different from other building materials. The principal of construction requires a deep understanding of the fabric reaction to forces.

Steps of tensile structure erection

- * Concept
- * Structural analysis
- * Detailing, Shop drawing & Connection details.
- * Patterning of membrane
- * Fabrication and painting of the structure
- * Installation and tensioning
- * Maintenance & cleaning education to end user.

Good Earth City Centre, Sector 50, Gurgaon



TENSILE STRUCTURE, LIGHT WEIGHT STRUCTURE, MEMBRANE COVERINGS



TENSILE STRUCTURE, LIGHT WEIGHT STRUCTURE, MEMBRANE COVERINGS

Atrium/Public places

These tensile structures can be designed as per the IS codes depending on the site location and requirement of the client.
IS-800, IS-456, IS-875



IS-875

Part-1 Dead loads

Part-2 Imposed loads

Part-3 Wind loads

Part-4 Snow loads

Part-5 Special loads and load combinations

Earthquake load being covered in a separate standard, namely IS 1893 (Part-1)





TENSILE STRUCTURE, LIGHT WEIGHT STRUCTURE, MEMBRANE COVERINGS



Gomi Riverfront Park (Lucknow)



Gomi Riverfront Park (Lucknow)

TENSILE STRUCTURE, LIGHT WEIGHT STRUCTURE, MEMBRANE COVERINGS

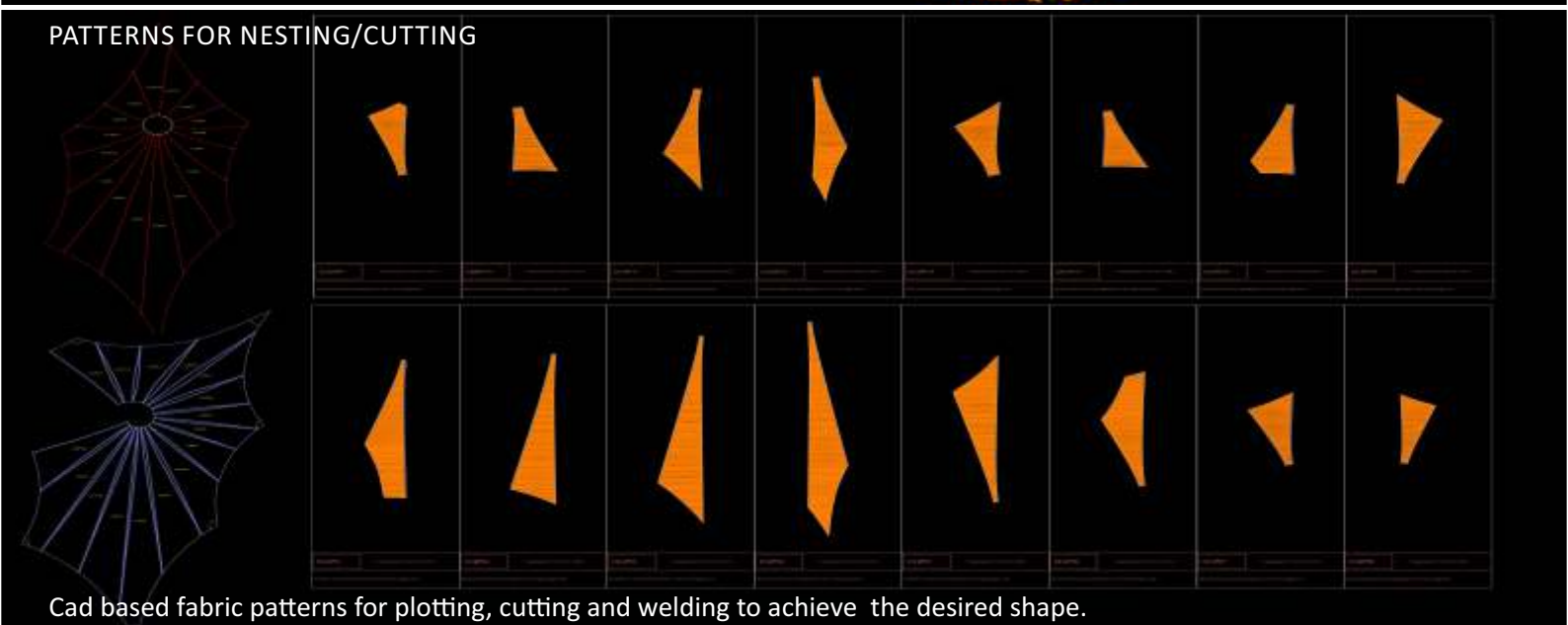
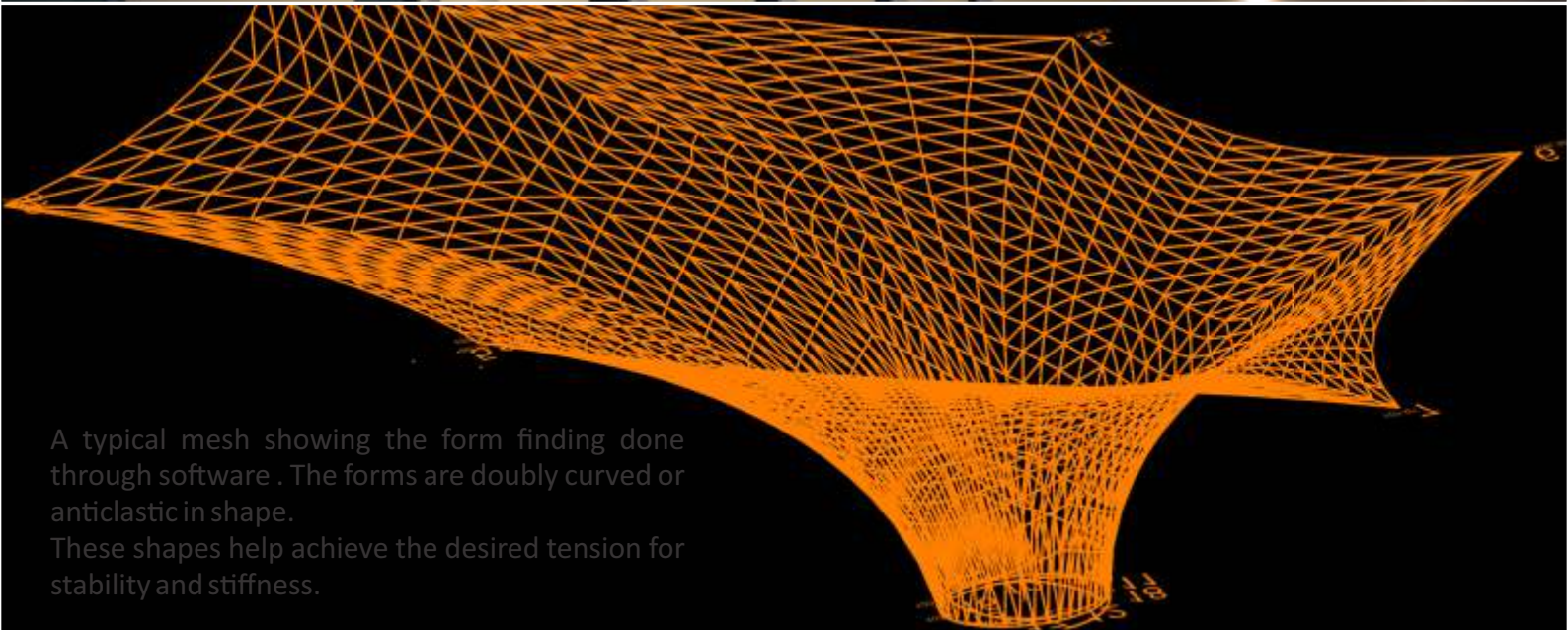

Cad based fabric patterns for plotting, cutting and welding to achieve the desired shape.

TENSILE STRUCTURE, LIGHT WEIGHT STRUCTURE, MEMBRANE COVERINGS

Car park:

ENCON tensile membrane structures offer a range of car-park solutions. The cantilevered car park allow the cars to be parked without any hindrance.



Durability:

We use reputed global fabric brands which have good warranties and low maintenance.



TENSILE STRUCTURE, LIGHT WEIGHT STRUCTURE, MEMBRANE COVERINGS



Chhatarpur, New Delhi



TENSILE STRUCTURE, LIGHT WEIGHT STRUCTURE, MEMBRANE COVERINGS



Chattarpur farms, New Delhi

TENSILE STRUCTURE, LIGHT WEIGHT STRUCTURE, MEMBRANE COVERINGS



TENSILE STRUCTURE, LIGHT WEIGHT STRUCTURE, MEMBRANE COVERINGS



Ashiana Housing Ltd, Gurgaon



Concept images

TENSILE STRUCTURE, LIGHT WEIGHT STRUCTURE, MEMBRANE COVERINGS



TENSILE STRUCTURE, LIGHT WEIGHT STRUCTURE, MEMBRANE COVERINGS

Walk way Covering:

ENCON has a range of architecturally appealing walk way covering options. Besides being functional, they add appeal to the landscaped area.

Marmo Home, Okhla, Delhi



Shikshantar School, Gurgaon



TENSILE STRUCTURE, LIGHT WEIGHT STRUCTURE, MEMBRANE COVERINGS



TENSILE STRUCTURE, LIGHT WEIGHT STRUCTURE, MEMBRANE COVERINGS



TENSILE STRUCTURE, LIGHT WEIGHT STRUCTURE, MEMBRANE COVERINGS

Sports Covering:

Tensile membrane is the best material for covering of basketball courts, badminton courts, swimming pool covering, TT rooms etc. The covering provides a good waterproof and shaded area. The areas can be air conditioned also.



Sports Shade Structures are designed to protect players or children on many different types of outdoor athletic courts, sport fields, play areas and schools. Depending on your requirements, our sports courts shade designs can cover entire basketball courts, skateboard parks, tennis courts, badminton courts, roller skating rinks, volleyball courts, and other play areas for sporting events, as well as school PE areas.

We can give you shading only option as well as waterproof covering options.

These structures can be structurally designed as per relevant codes for complete safety and stability



TENSILE STRUCTURE, LIGHT WEIGHT STRUCTURE, MEMBRANE COVERINGS



Sri Narayn School
Gurgaon



Delhi Public School
North Kolkata



DPS, Greater Kailash, New Delhi

TENSILE STRUCTURE, LIGHT WEIGHT STRUCTURE, MEMBRANE COVERINGS

Multi purpose covering:

Tensile structures can be used for various customized applications.



TENSILE STRUCTURE, LIGHT WEIGHT STRUCTURE, MEMBRANE COVERINGS



TENSILE STRUCTURE, LIGHT WEIGHT STRUCTURE, MEMBRANE COVERINGS



TENSILE STRUCTURE, LIGHT WEIGHT STRUCTURE, MEMBRANE COVERINGS

Textile/ Membrane/ Architectural Facade:

It is the latest in building facade. It can provide shading, at the same time create iconic elevations. It also increases the building insulation vis-a-vis other elevation materials like glass etc. Burj Al Arab at Dubai is popular example of fabric being used in elevations. ENCON can give shape to interesting forms , colors and textures.



Concept image



ENCON Factory

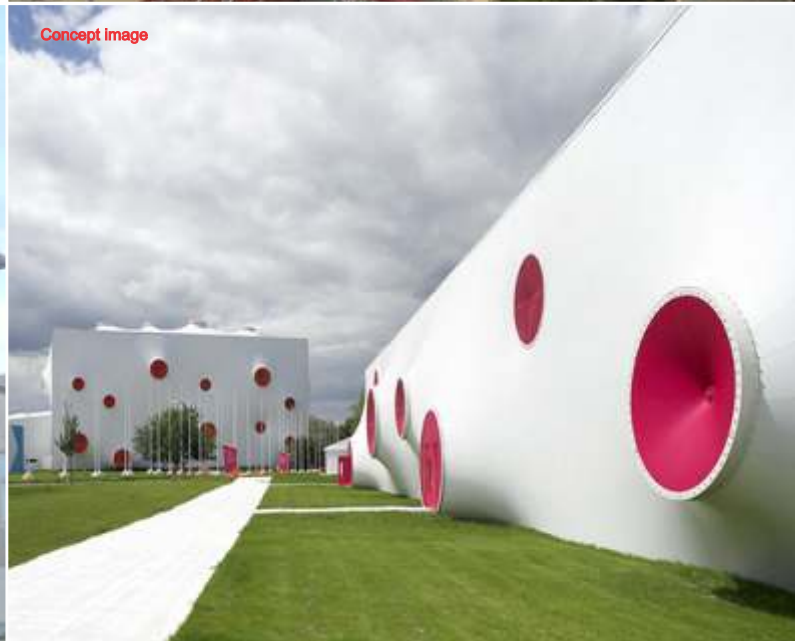

Concept image



Concept image



Concept image

Entrance Canopy:

ENCON's entrance canopies can highlight the entrance, add character to the building and also protect against rain and sun.



TENSILE STRUCTURE, LIGHT WEIGHT STRUCTURE, MEMBRANE COVERINGS



TENSILE STRUCTURE, LIGHT WEIGHT STRUCTURE, MEMBRANE COVERINGS



TENSILE STRUCTURE, LIGHT WEIGHT STRUCTURE, MEMBRANE COVERINGS



TWO HORIZON CENTER, GOLF COURSE ROAD, Gurugram, Haryana



LANDSCAPE ELEMENTS

Landscape Elements

WOW! That's the word for these elements. They are a delight for landscape consultants. You can add Zing to landscape areas. You can also use them as a light source. A range of colors to compliment the latest architectural trends.



LANDSCAPE ELEMENTS



Malibu Towne



LANDSCAPE ELEMENTS



LANDSCAPE ELEMENTS



LANDSCAPE ELEMENTS



LANDSCAPE ELEMENTS



Barakhamba road, Connaught place

LANDSCAPE ELEMENTS



GLO Kitchen & Bar, DIFC, Dubai

Gazebo / Cabana



Gazebo / Cabana



Gazebo / Cabana



ITC Grand Bharat Gurgaon

Gazebo / Cabana

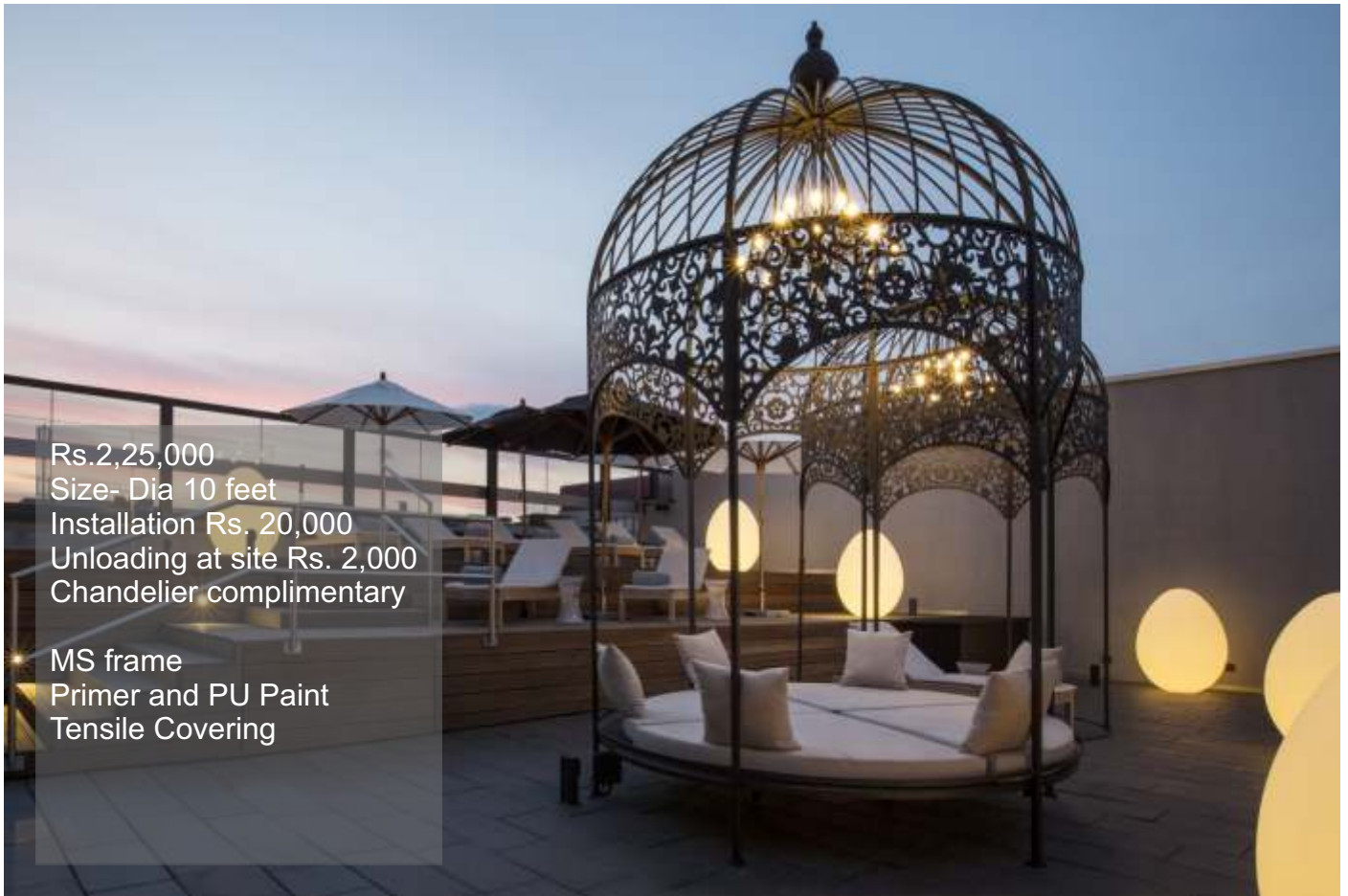

Rs.2,25,000
Size- Dia 10 feet
Installation Rs. 20,000
Unloading at site Rs. 2,000
Chandelier complimentary

MS frame
Primer and PU Paint
Tensile Covering



Rs.1,50,000
Size- 12x12 feet
8 Curtain Rs. 20,000
SS Curtain rod Rs. 4,000
Installation Rs. 20,000
Unloading at site Rs. 2,000
Chandelier complimentary

MS frame
Primer and PU Paint
Tensile Covering



The Work-Worm Architects

Gazebo / Cabana



Gazebo / Cabana



Gazebo / Cabana



Rs.3,30,000
Size- Dia 12 feet
Installation Rs. 40,000
Unloading at site Rs. 4,000
Chandelier complimentary

Cast Iron frame
Primer and PU Paint
Tensile Covering on top

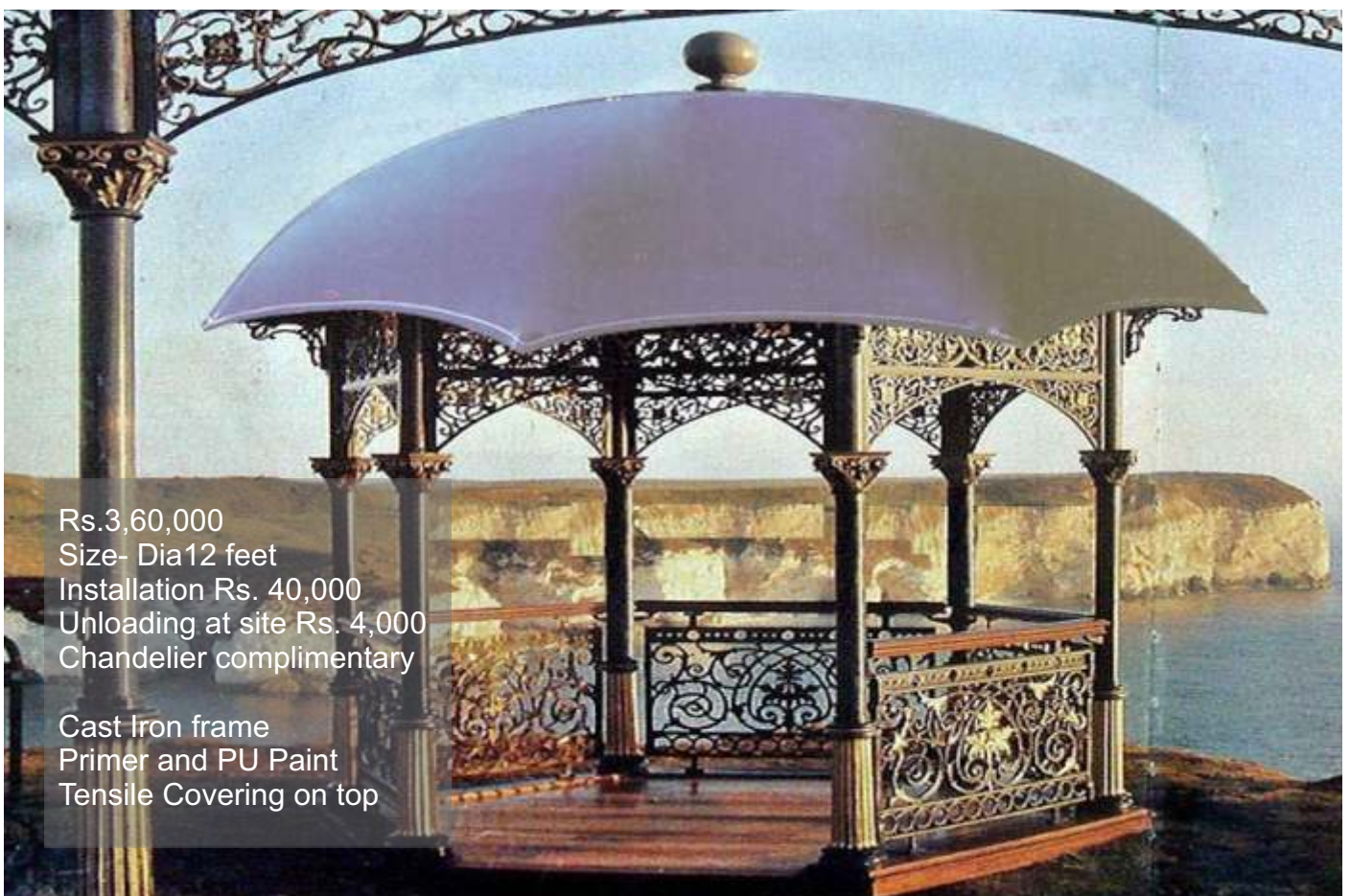

Rs.3,60,000
Size- Dia12 feet
Installation Rs. 40,000
Unloading at site Rs. 4,000
Chandelier complimentary

Cast Iron frame
Primer and PU Paint
Tensile Covering on top



Gazebo / Cabana





Gazebo / Cabana







Gazebo / Cabana



Pergola



Powder coated(2 Layer)
Aluminum frame Rs.1,25,000

Size- 12x12 feet
8 Curtain Rs. 20,000
SS Curtain rod Rs. 4,000
Installation Rs. 20,000
Unloading at site Rs. 2,000
Chandelier complimentary

RCC Base plate Rs. 2500 each

Option-1

Powder coated
Aluminum frame Rs.1,40,000

Option-2

Primer and PU Painted
MS frame Rs.1,25,000

Size- 12x12 feet
8 Curtain Rs. 20,000
SS Curtain rod Rs. 4,000
Installation Rs. 20,000
Unloading at site Rs. 2,000
Chandelier complimentary

Tensile Covering
Rs.250 per sqft extra if required



Pergola



Pergola



Pergola



Pergola



Pergola



Pergola



Pergola



Pergola



Rs.1,35,000
Size- Dia 15x10 feet
Installation Rs. 20,000
Unloading at site Rs. 2,000
Chandelier complimentary

Design cutting on pillar
Rs. 5000 per pillar extra

MS frame
Primer and PU Paint
Aluminium frame
with 5 year warranty wicker

Pergola

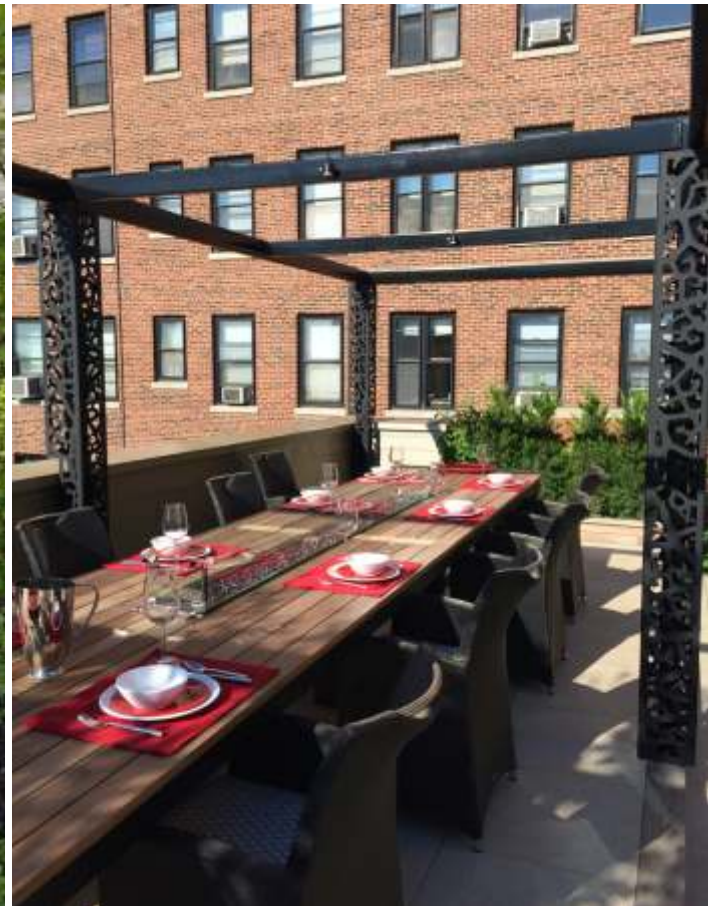

Pergola



Pergola



Pergola



Pergola



Pergola



Pergola



Pergola

Why a Pergola?

*It creates a interesting outdoor place to unwind, relax, socialise with friends & family.

*Lifestyle entertainment hub

Add comfortable seating, accent tables, outdoor rug and other accessories.

*Barbecue, have chilled wine or enjoy the breakfast

*Improve the landscape of your home.

Pergolas are designed to support climbing, hanging plants.

Types of Pergola

* Powder coated Aluminum frame

* PU painted M.S frame

* WPC (Wood plastic composite)

* Thermo Pine Imported Wood



Pergola



Pergola



Pergola



Pergola



Pergola



Pergola



Pergola



Pergola



Powder Coated Aluminum Pergola at a Residence
Punjabi Bagh



KIOSK



KIOSK





GOOD EARTH
Sector 50, Gurgaon

KIOSK



Skylight Shading System:

Skylights though essential for sunlight sometimes do add to heat and glare. With skylight shading system the amount of sunlight coming in the building can be calibrated to our comfort level. It allows you the option of having sunlight in winter and diffusing the glare in summer. It will reduce your energy bills. The shading system can be motorized or manual. They can be inclined or horizontal.



Retractable Roof:

Retractable roof allows you to come closer to nature.

Roof can be opened or slid back, to allow fresh air, to enjoy the sun or moonlit sky.

Roof can be closed during extreme weather conditions.

The Retractable roof system can be motorized or manual.

They can be inclined or horizontal.





RETRACTABLE/OPENABLE ROOF AND SUN CONTROL SYSTEMS(Motorized & Manual)





Sarvodaya Enclave, Delhi



Farm at Vasant Kunj, Delhi





Koramangala, Bangalore



Koramangala, Bangalore







PREFAB LIGHT WEIGHT ROOM/ CONTAINER, OFFICE & RESIDENCE

ENCON is the most innovative manufacturer of prefabricated shelters/ rooms. We design and manufacture special prefabricated to ready made prefabricated Shelters/Rooms. We offer unmatched quality range of prefabricated Shelters/ coverings made from premium quality FR materials. We are engaged in commissioning, consultancy and designing of our prefabricated Shelters/Rooms

Buy a pre-fabricated house/ Office / Multipurpose and get it assembled on your site

- Fast & cheaper than conventional construction.
- Insulated, comfortable in adverse weather.
- Fascia design options.
- Relocation & Expansion possible.
- All weather material used.
- Fungus & Termite proof.
- No need of painting
- Light weight



PREFAB LIGHT WEIGHT ROOM/ CONTAINER, OFFICE & RESIDENCE

Applications:

- Residential floors, House Extensions
- Restaurant, Pubs
- Project office sites
- Slum rehabilitation
- Police / military / paramilitary camps
- Coverings where permanent construction is not allowed
- Education / healthcare



PREFAB LIGHT WEIGHT ROOM/ CONTAINER, OFFICE & RESIDENCE



Riding club, New Delhi



PREFAB LIGHT WEIGHT ROOM/ CONTAINER, OFFICE & RESIDENCE



PREFAB LIGHT WEIGHT ROOM/ CONTAINER, OFFICE & RESIDENCE



PREFAB LIGHT WEIGHT ROOM/ CONTAINER, OFFICE & RESIDENCE

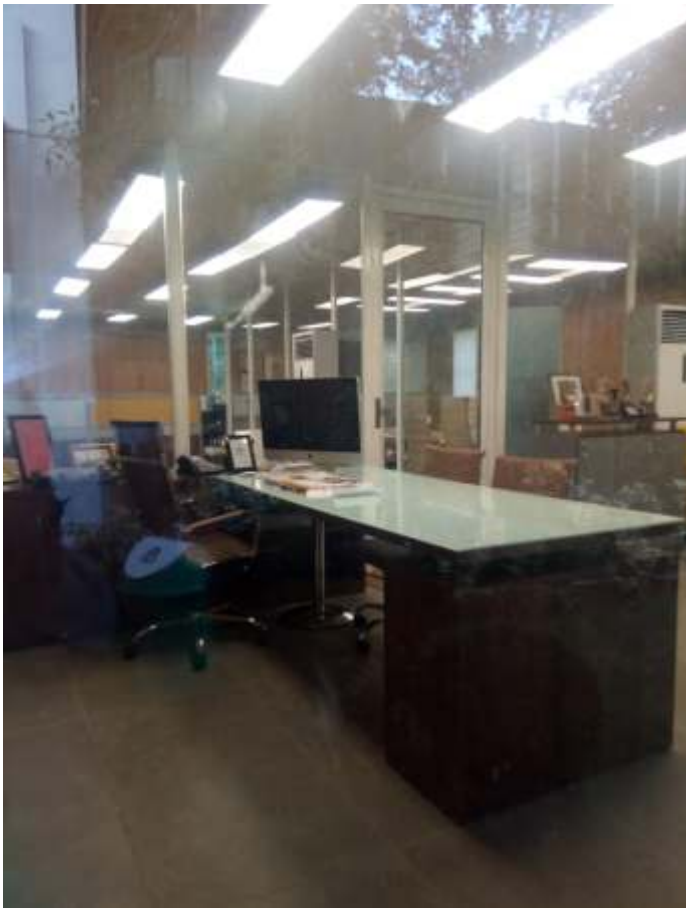

Luxury Tent



Specification

Frame :

PU Primer & PU painted M.S tubular frame.

Covering membrane:

Water proof
Fire retardant
Heat welded at joints
5 year warranty
Blackout membrane

(Option of single layer & double layer membrane cladding)

Door and Windows

Sliding or openable : UPVC/ powder coated Aluminium door and windows with 5 mm clear glass

Plan area: 14'x14'=196 sqft
Double layer membrane Rs. 2000 per sqft
Single layer membrane Rs. 1750 per sqft

Plan area: 10'x10' =100 sqft
Double layer membrane Rs. 2250 per sqft
Single layer membrane Rs. 2500 per sqft

Terms

Flooring extra
IGST@18% extra
Installation Rs. 25000
Freight / Cartage extra

PREFAB LIGHT WEIGHT ROOM/ CONTAINER, OFFICE & RESIDENCE



Greater Kailash I

PREFAB LIGHT WEIGHT ROOM/ CONTAINER, OFFICE & RESIDENCE



Cottage

Specification

Exterior Cladding

Per coated sheet Puf insulated sandwich panel for roof and walls to provide protection from sound, heat and cold.

Frame work

Primer & painted MS frame work designed to withstand high wind and tremors.

Flooring

Base flooring: Primer & painted MS tubular frame with cement boards.

Flooring top: Laminated /WPC/ Wooden flooring, carpet tiles

Internal Wall

Textured Mesh panel cladding
Termite & moisture proof
No need to Paint or Polish
UV Resistant

Doors & Windows

Powder coated Aluminium section/UPVC Door & Windows with 5 mm clear glass .
DGU glass is recommended (Additional cost)

Plumbing & Toilet fixtures

Complete Toilet with Jaquar fittings and UPVC pipes

Electrical fittings

Complete fittings with Crabtree switch/ socket, Branded LED Light & Fans.

Terms

Transportation, Unloading & Crane charges extra
Boarding for installation team to be arranged by the client.

Payment terms : 50% advance. 30% after erection MS frame and balance before dispatch.

Delivery time : 60 To 90 days.



Cottage



PREFAB LIGHT WEIGHT ROOM/ CONTAINER, OFFICE & RESIDENCE



Neemrana's Glasshouse on The Ganges



Neemrana's Glasshouse on The Ganges

Insulated room



Insulated room



Insulated room



Insulated room



PREFAB LIGHT WEIGHT ROOM/ CONTAINER, OFFICE & RESIDENCE



PREFAB LIGHT WEIGHT ROOM/ CONTAINER, OFFICE & RESIDENCE



PREFAB LIGHT WEIGHT ROOM/ CONTAINER, OFFICE & RESIDENCE



AWNING & CANOPY

Fixed Awning

- *Any shape & size feasible
- *Small size are prefabricated

- *Big sizes are fabricated at site
- *M. Steel tubular framework spray painted
- *Fabric as per your choice



Kingdom of Dreams, Gurgaon



AWNING & CANOPY



Helios, Neemrana

AWNING & CANOPY

Terrace Awning

*Per fabricated ready to install retractable arm awning operated by gearbox with removable handle.

*Slope is adjustable between 10° to 45°

*Fabric as per your choice

Options:- 1) Manual or Motorised.

2) Hood: To cover the gap between the roller tube and wall to avoid water seepage





AWNING & CANOPY

Window Awning

*Per fabricated ready to install fixed or folding awning operated by pulley & cord arrangement.

*Fabric as per your choice

*Options : 1) Manual or Motorised.



AWNING & CANOPY



AWNING & CANOPY



Farm, New Delhi



Giorgetti, New Delhi

AWNING & CANOPY





AWNING & CANOPY

Bull Nose

*Per fabricated ready to install fixed or folding awning operated by pulley & cord arrangement.

*Shape is one quarter of a sphere.

*Fabric as per your choice

Options: 1)Folding or Fixed



AWNING & CANOPY



AWNING & CANOPY



Farm at Faridabad

AWNING & CANOPY

Vertical Awning

- *Pre fabricated ready to install awning.
- *The fabric can be moved vertically up or down.
- *The drop bar moves on steel wires and is operated by a gear box with removable handle.
- *Fabric as per your choice

Options:

- *Manual or Motorised.
- *Hood: to cover the gap between the roller tube and wall to avoid water seepage.



Connaught Place, New Delhi



Connaught Place, New Delhi



Galleria Market, Gurgaon

AWNING & CANOPY

Drop arm Awning

*Per fabricated ready to install retractable awning operated by gear box with a removable handle.

Options:

*Manual or Motorised.

*Hood: to cover the gap between the roller tube and wall to avoid water seepage.



MESH SHADING APPLICATION

Mesh Shade cloth keeps the area shaded and is breathable. Excellent level of UV block and shade factor. Designed to breathe, it allows breeze to flow through, significantly reducing temperatures beneath. The colors remain vivid for years. Economical visa-vis other tensile membranes. Range of colors to compliment architectural trends. Provides ideal shade solutions for school playgrounds, child-care centre, sporting facilities, car park and other commercial locations.

Shade structures have become an integral part of open areas in Educational institutions for covering playground, recreational areas, swimming pools, vehicle drop areas etc.



MESH SHADING APPLICATION

PLAYGROUNDS

Protection from harmful UV Rays:

The skin of children is extremely sensitive, and research has also shown that high exposure to UV Rays is one of the major causes of skin cancer. In some countries like Australia & the GCC countries, it is mandatory to have shading over children playgrounds to protect the young children from the exposure to high UV rays. In India too all the progressive schools have started to use this solution to protect the health of their students.

Better usage of Schools playground and other open area:

During certain periods of the year, the temperatures are too high, for children to be comfortably playing in the outdoors. Providing shade cover to the playgrounds will increase the usability of the play areas.

Even during lunch breaks, the open areas can be used by the children, for dining etc., if they are shaded. Thus optimum utilization of scarce land resources can be assured by shading these areas.



MESH SHADING APPLICATION

CAR & BUS PARKING AREA

Better comfort:

When the outside temperature is above 36° celsius, and cars/buses are parked in the open, the temperature inside a parked vehicle reaches 50° to 60° Celsius, thus making it feel like an oven, when entering the car/bus on a hot day. Shades over the parking area, ensure a highly comfortable atmosphere inside the car/bus, even on hot days.

Reduced maintenance and better interiors:

In some parts of India the temperatures soar as high as 48° celsius outside. The high temperatures and exposure to UV has highly deteriorating effect on the interiors of the car/bus, like seats, dashboard, rubber trims, etc., resulting in high maintenance costs. Shaded parking area reduce this deterioration, and keeps the interiors better looking for a longer period of time.



MESH SHADING APPLICATION

SWIMMING POOL AREA:

Protection from harmful UV Rays:

Most people must have experienced how the skin gets tanned when you go for swimming regularly. This is again due to high UV exposure, which is not good for the health of the skin of young children. During swimming a large part of the body is exposed to UV rays. Shading of the Swimming Pool reduces this harmful exposure substantially, and also makes the swimming experience much more enjoyable due to a comfortable shaded atmosphere.

Water conservation:

Shading of the Swimming Pool also reduces the loss of water due to evaporation under the heat, thus reducing the usage of water.



MESH SHADING APPLICATION

FEATURES & BENEFITS

*Knitted lock-stitch construction for fray and tear resistance, offers more air movement and better channeling of cool breezes

*UV-stabilised HDPE monofilament and tape yarn provides optimal balance between strength and UV block, with easy fabrication and minimal maintenance

*Strong HDPE won't rot or absorb moisture

*Stentered (heat set) virtually eliminates any possibility of shrinking once installed and provides ease of fabrication

*UV Block range 89.3%-97.7% reduces sun exposure for safe and extended time outdoors

*10-year UV degradation warranty on fabric

*100% lead and phthalate free for a healthier environment

*Greenguard® and Oeko-Tex® certified provides confidence in operational quality assurance

*Engineered in Australia for the harshest conditions

*100% recyclable



MESH SHADING APPLICATION



MESH SHADING APPLICATION



Udman resort, Delhi

MESH SHADING APPLICATION



Residence, New Friends Colony

MESH SHADING APPLICATION



VERTICAL SCREEN / SEE THRU SCREEN

Vertical Screen / See thru screen allow uninterrupted outdoor living. The retractable mechanism can be manual or motorized as per requirement.

These are retractable innovative all weather screen which

- * Unblocks view
- * Blocks the chill
- * Blocks gusty wind
- * Blocks birds , flies, mosquitoes
- * Blocks rain
- * Blocks hot breeze
- * Blocks dust
- * Facilitates air-conditioning

Suitable for all outdoor applications like:

- * Fresco dining
- * Gazebo/ Cabana/ Marquee
- * Roof top restaurant
- * Terrace, Balcony covering
- * Garden restaurant
- * Patio
- * Conservatory

Material:

- * Transparent PVC membrane
- * Aluminum Sections
- * SS guide cables



VERTICAL SCREEN / SEE THRU SCREEN



VERTICAL SCREEN / SEE THRU SCREEN



VERTICAL SCREEN / SEE THRU SCREEN



Chaayos, Noida



VERTICAL SCREEN / SEE THRU SCREEN



Residence, New Delhi



Residence, New Delhi



ROLLER BLIND

ENCON'S blinds come in a variety of Screens, Translucent and blackout options. In ENCON Roller blinds, the fabric is inserted in specially designed grooved roller tubes for proper installation of fabrics and uniform lifting. Available in wide range of fabrics form USA, Germany, France and across the globe. Our unique automation controls allow multiple blinds to maintain the same level when being raised or lowered.

The advantages of Roller Blinds

- * Simple and easy to use
- * Low maintenance
- * Light weight
- * Easy to install
- * Big collection of fabrics
- * Reduces glare
- * More affordable in comparison to several other blinds
- * Easy to operate- manually or remote
- * Resistance to adverse climatic condition

We have total side blackout solutions in blinds



Leela hotel Gurgaon



Leela hotel Gurgaon



Encon Gurgaon



Vasant kunj, Delhi



Design element, Screen, Wall feature:

Fabric being a flexible material can be used to create organic, free flowing forms. It results in stunning forms and sculptures which accentuated with lights can give results which no material can match . We can play with translucent and opaque fabrics.

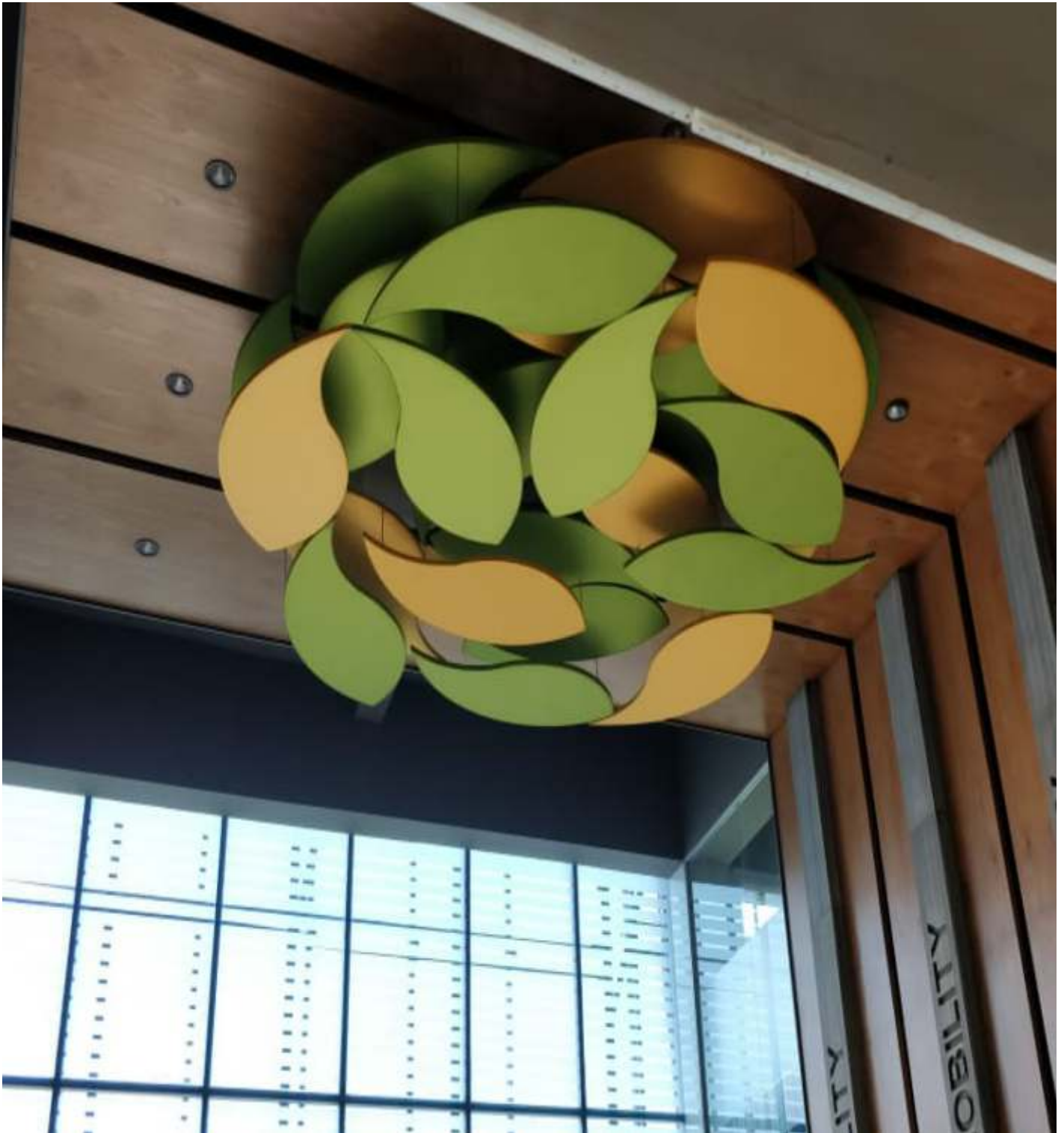

INTERIOR DESIGN ELEMENTS, WALL FEATURE, ART



Woox, Sohna road, Gurgaon

Membrane stretch ceiling element



Membrane Art element in atrium



Gurgaon

INTERIOR DESIGN ELEMENTS, WALL FEATURE, ART



AEZ Food Court , Ghaziabad

INTERIOR DESIGN ELEMENTS, WALL FEATURE, ART





CUSTOMIZED LIGHTS

Light:

Customized light can be made for interior and exterior. We can customize Lights in any form and shape in exceptionally large sizes, which conventional light suppliers cannot execute.

You can create your design and size. It being customized, will be exclusive very unlike the popular shapes which are available in the market. It gives a chance to add designer element to your interior and exterior.



CUSTOMIZED LIGHTS



Looks, Galleria Market, Gurgaon

CUSTOMIZED LIGHTS



CUSTOMIZED LIGHTS



CUSTOMIZED LIGHTS



SAS Tower Medicity, Gurgaon

CUSTOMIZED LIGHTS



Bar, Kailash Colony



medanta
Gurgaon

Stretch Ceiling:

Innovative covering for walls and ceiling. It enhances space and creates an absolutely amazing effect.

Flawless finish, completely uniform appearance due to cutting edge technology. Width of up to 3mtr without joint or seams. Clean, neat work with minimum disturbance to existing interiors, very unlike the POP or conventional false ceiling. Quick to install Water repellent, does not blister or crack.



INTERIOR AND STRETCH CEILING



INTERIOR AND STRETCH CEILING

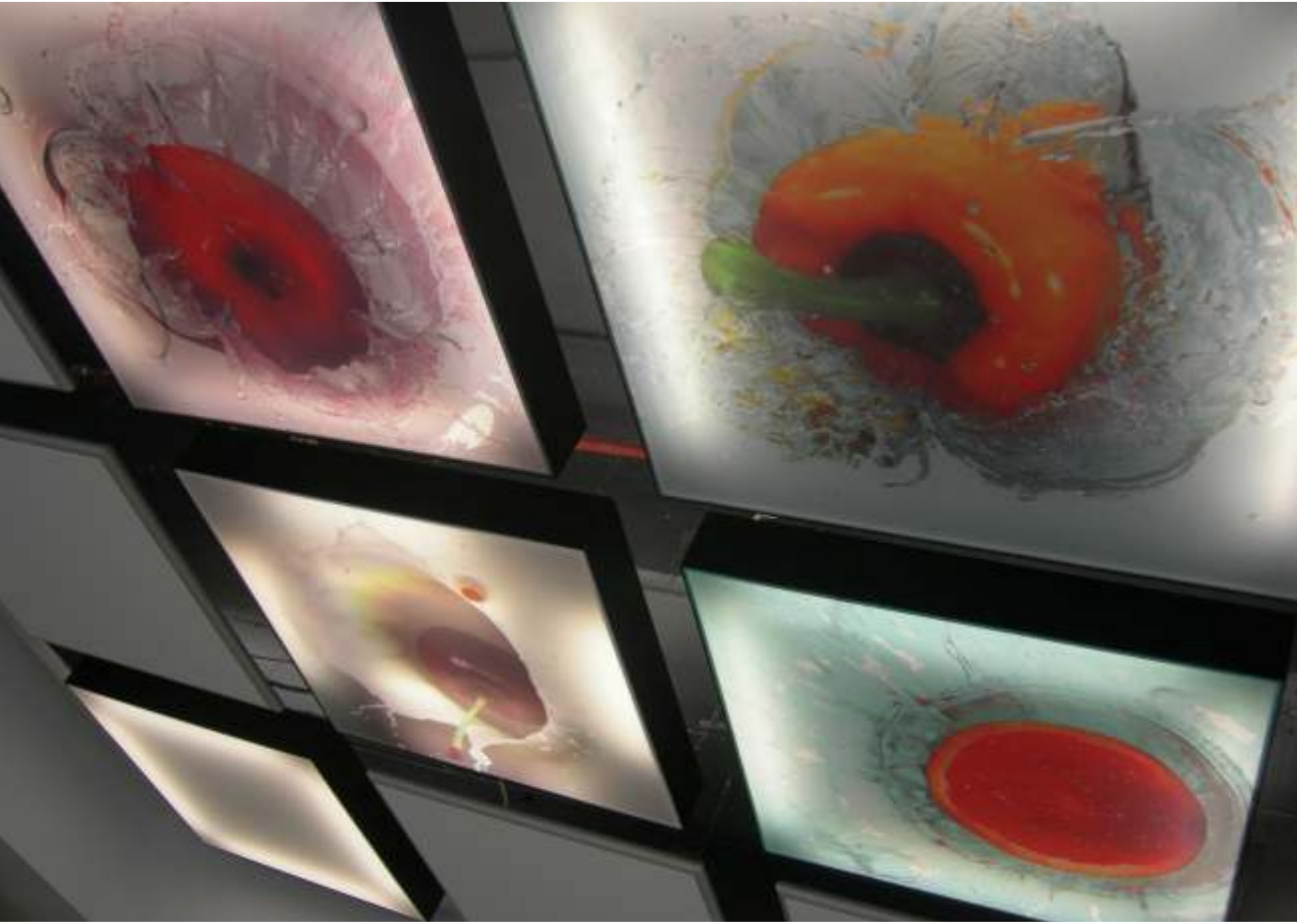

INTERIOR AND STRETCH CEILING



Costa Coffee, Mumbai

Space divider/ Barricade for coffee shop inside a mall

INTERIOR AND STRETCH CEILING



T2 Terminal, Mumbai

Stretch Membrane over the food court counter



T2 Terminal, Mumbai

Membrane Canopy for Coffee counter

CEILING & WALL PANELING



Ceiling & Wall paneling
Sector 56, Gurgaon



Wall paneling
Sector 37, Gurgaon

CEILING & WALL PANELING





POLYCARBONATE

Advantages of Multiwall Polycarbonate Sheet

- Affordable
- Impressive flexibility
- Energy- saving
- Durable
- Longer Lasting
- Shatter-resistant
- Better Light Diffusion and UV Protection
- Easy handling & quick to install
- Provides great protection against UV
- Maintans its look for a long time
- Virtually unbreakable
- Better Insulation & can be customized



POLYCARBONATE



POLYCARBONATE



POLYCARBONATE



POLYCARBONATE

General applications of Multiwall Polycarbonate Sheet

- Sky light
- Walkways, domes, pyramids
- North light glazing and industrial cladding
- Swimming pool covers
- Partition wall / safety glazing
- Sound / noise barriers
- Green houses

Residence at Sushant lok 1 Gurgaon



Farm at Faridabad



Citrus, Sector -29 Gurgaon



French Embassy



WROUGHT IRON/ CAST IRON/ FRP CANOPY

Not only is a Wrought iron/ Cast iron/ FRP Canopy a luxurious accent for your home, it also adds the functionality of protection for your door as well as shelter from rain and sun for you and your guests. No two canopies are alike and they are custom built to accommodate any size, space and design. This is where extreme beauty meets functionality.



WROUGHT IRON/ CAST IRON/ FRP CANOPY

Sector 37, Gurgaon



WROUGHT IRON/ CAST IRON/ FRP CANOPY



Banquet

ENCON offers banquet hall structure solutions . We offer fixed roof and retractable roof solutions. The possibility of customization is immense. Banqueting solution with a European feel. Surround yourself with breathtaking views of your surroundings including the sky, in a Patio Enclosure solarium. Our glass-enclosed room makes a stunning addition to any banquet. Energy-efficient double-wall air insulated sheet, provides improved heating and cooling performance, adding to your comfort.

- * Hassle free turnkey installation.
- * Design & Erection.
- * Water proof.
- * Fire retardant.
- * Can be dismantled and shifted to new location.



Banquet



Udman Hotel, Mahipalpur, Delhi



Divya Aangan, Sirsa



Banquet



French Victorian Conservatory

The incredible Victorian conservatory is a true classic which has been inspired from the late Victorian architecture.

The classic style will capture the eye of any beholder.

Victorian conservatories can be adapted to suit any style of home / restaurant.

Whether you are looking for a outdoor lounge or outdoor dining space this conservatory style will add significant value to your property.

Encon offers customers a chance to choose the type of finish applied to the conservatory for that added splash of color.

All the best of the Victorian era is brought to life in this conservatory style, the highlight being the vast panoramic views, perfect for admiring ones outdoor all year around.



French Victorian Conservatory



French Victorian Conservatory



French Victorian Conservatory



French Victorian Conservatory

You have always wanted to bring in a bit of the outdoors and now is the time to consider adding a sun room, conservatory or enclosing a little used sun porch for year-round enjoyment. Consider the space gained by converting an open porch into a 4-seasons sunroom. Imagine morning coffee in your own sun room or the dramatic transformation of your home into your castle with the addition of a conservatory.



French Victorian Conservatory



French Victorian Conservatory



LOUVER/ PERGOLA

Louver shading system can calibrate the amount of sunlight coming in the building to our comfort level. It allows you the option of having sunlight in winter and diffusing the glare in summer. It will reduce your energy bills. The shading system can be motorized or manual. It enhances the facade and the ambience. High quality maintenance free material ensures long life.



Range (Open able or Fixed):

- Roof
- Facade
- Gazebo/ Cabana
- Gate & Fence
- Screen



Customization:

Encon's louver system can be installed vertical or horizontal or as per the angle of the sun. We will be happy to customize as per your design or your functional requirement.

Automation:

Encon's louver can be automated.

Automation will help optimize the sun. Sun light can be regulated to reduces the day light and air conditioning requirement. These can be operated by a switch, remote or building management systems from sensor control to PC control and internet control.

LOUVER/ PERGOLA



OFFICE BREAKOUT AREA



OFFICE BREAKOUT AREA



TENSILE UMBRELLA

Encon's tensile fabric umbrellas can be installed on a variety of surfaces, including concrete footings and slabs, timber decks and boardwalks. These fabric canopy structures are easy to transport and arrive to site fully preassembled or in component form for easy erection. Our Architectural Umbrellas and Modulares are able to withstand strong winds.



UMBRELLA AND PARASOLS

Japanese Umbrella



JU- 01

Frame

* 38mm ϕ Powder coated aluminum frame

Fabric

* Dust repellent, Water repellent polyester fabric

Base Plate

* Weight : 15kg

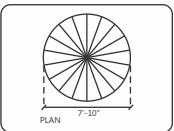
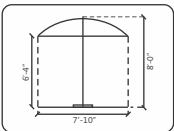
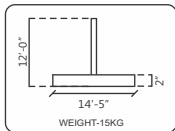

Wooden Frame Umbrella



WU- 20

Frame

* 38mm ϕ wooden frame WU-20

* 48mm ϕ wooden frame WU-21

Fabric

* Dust repellent, Water repellent polyester fabric

Base Plate

* Weight : 10/30kg

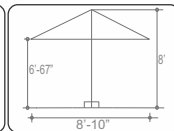
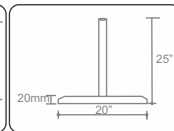
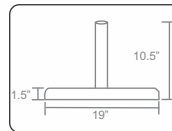

Heavy Duty Side Pole Umbrella



SPU- 02

Frame

* 75mm x 55mm Powder coated aluminum frame

Fabric

* Dust repellent, Water repellent polyester fabric

Base Plate

* Weight : 66kg

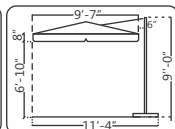
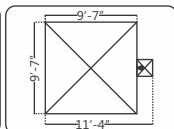
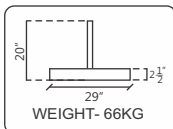

Aluminum Frame Umbrella



EUP-01

Frame EU-01

* 38mm ϕ Powder coated aluminum frame

Fabric

* Acrylic fabric(64 shades)
* PVC coated fabric (41 shades)

Base Plate

* Powder coated M.S. Plate.
* Rubber lining below the base plate to protect the floor from rust marks.
* Weight : 30Kg.
* Beveled edges.

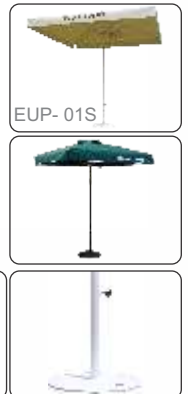
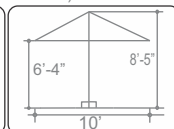
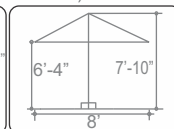
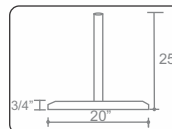

Encon has a range of Umbrellas right from light duty to heavy duty to side pole umbrellas and parasols. We have been customizing umbrella's for the fast food, cafe and hotel industry. Costa, Nirulas, Lite Bite, Leela Kempinski, ITC Maurya Sheraton, Supertech, Vatika Coriander leaf, The Suryaa , Marriot, Khimsar Fort, Calcutta Cricket & Football club, Taj Palace, India Habitat World have been using our umbrellas for a number of years. We can provide Umbrellas in PVC Coated, fire retardant, Shading Mesh or European acrylic fabrics. These fabrics have good warranties ranging upto 5yrs against fading. Size: 6'-0" to 16'-0"

Balcony extension



Balcony extension



Balcony extension



Beautifully crafted cantilevered Balcony manufactured in house with metal or wooden deck flooring



PRODUCTION FACILITY & MANPOWER

Fabric Room:

In house fabric welding facility



Workshop:

In house pipe bending machine and complete fabrication setup.
We can weld M.S, SS and Aluminium at our works.



Manpower:

The most talented and experienced manpower in the industry is working with us.

SHORT LIST OF OUR ESTEEMED CLIENTS



SHORT LIST OF OUR ESTEEMED CLIENTS



ENCON[®]



Mr. Sandeep Thareja
Director

www.encon-india.com
www.tensileindia.com

mobile +919810165187

email marketing@encon-india.com

address 711 A, Pace City-II, Sector-37-II
Gurgaon - 122001 (Haryana) India